

# MS FRAM

MS Fram is named after explorer Fridtjof Nansen's most famous polar ship. She is the newest, most luxurious ship in our fleet and is specially designed for cruising Arctic and Antarctic waters. The technical standard is state-of-the-art and her reinforced hull enables her to travel safely in these icy waters. MS Fram has 128 stylish and comfortable cabins and many high standard suites. The panoramic lounges and the wide deck spaces give every guest the opportunity to enjoy a fantastic view on this masterpiece of an Arctic cruise ship.

Flag:	Norwegian
Ship yard:	Fincantieri, (I)
Year of construction:	2007
Gross tonnage:	11,647
Passengers:	318
Cabins:	128
Overall length:	114m
Beam:	20.2m
Iceclass:	1A/1B
Service speed:	13 knots

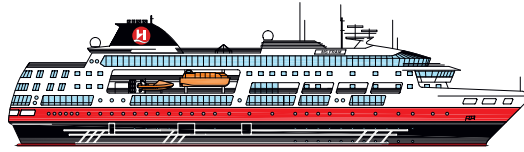

- DECK 8
- DECK 7
- DECK 6
- DECK 5
- DECK 4
- DECK 3
- DECK 2
- DECK 1

Deck 8

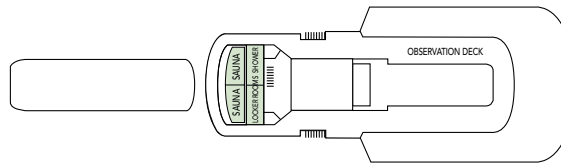

Deck 7

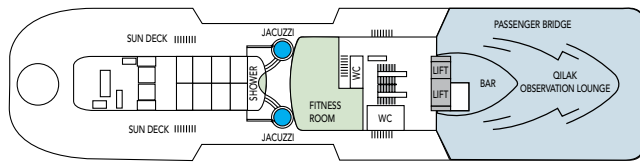

Deck 6

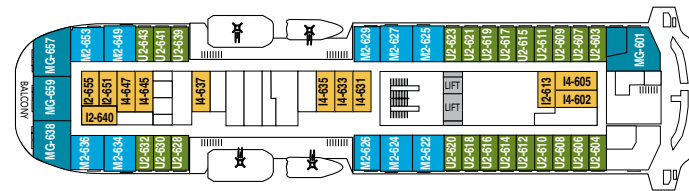

Deck 5

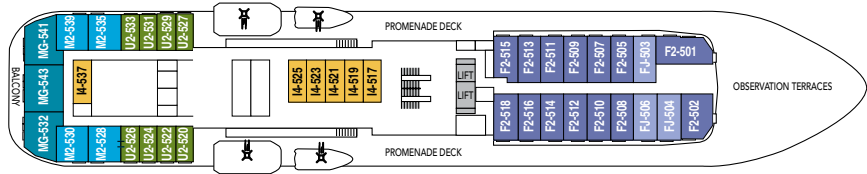

Deck 4

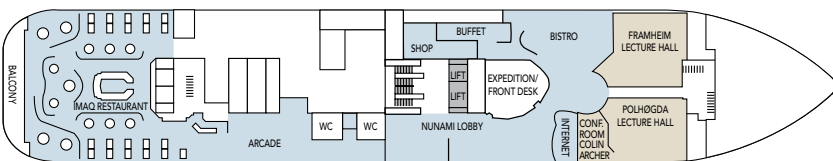

Deck 3

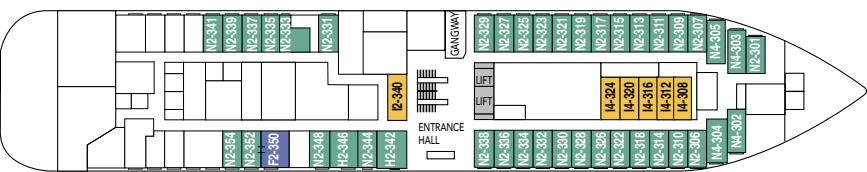

Deck 2

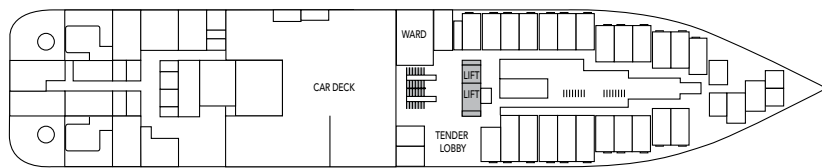

Cabin category F



Cabin category M



Cabin category N

Category	Description	Amenities	Location
<b>MG</b>	Outside grand suite	Sitting area, TV, minibar, double bed, shower/wc. Some have private balcony. MG 601 with separate sleeping area.	Deck 5, 6
<b>M</b>	Outside suite	One room, sitting area, TV, minibar, double bed, shower/wc.	Deck 5, 6
<b>F</b>	Outside superior cabin	Sitting area, TV, minibar, double bed, shower/wc.	Deck 3, 5
<b>U</b>	Outside cabin	One bed, one sofa bed, table, refrigerator, TV, shower/wc. (U 526*)	Deck 5, 6
<b>N</b>	Outside cabin	One bed, one sofa bed, table, refrigerator, TV, shower/wc. (N 352*)	Deck 3
<b>FJ</b>	Outside superior cabin	Sitting area, TV, minibar, double bed, shower/wc, limited or no view. (FJ 503 can be converted to twin beds)	Deck 5
<b>I</b>	Inside cabin	One bed, one sofa bed, refrigerator, TV, shower/wc.	Deck 3, 5, 6
<b>H</b>	Outside cabin	Cabin for disabled. One bed, one sofa bed, table, refrigerator, TV, shower/wc.	Deck 3

\* These cabins have upper and lower berths. Subject to change.